



Computing Services Centre

香港城市大學

City University of Hong Kong

USER GUIDE FOR **USING AV EQUIPMENT**

Yeung Kin Man Academic Building

Tin Ka Ping Lecture Theatre (LT-1)

Mr and Mrs Sze Chi Ching Lecture Theatre (LT-2)

For IT or AV support, please contact the CSC Service Desk at **3442-8340**

AV Control Panel

Display Source Select

1. Desktop computer
2. Desktop computer Extension
3. HDMI / Multiport Input (Use USB-C/HDMI devices)
4. Wireless Presentation for Apple Devices
5. Wireless Presentation for Microsoft & Android Devices
6. Presentation for Visualizer

Other Control

7. Volume Control
8. Lighting Control
9. Preview Monitor Control
10. Main Projector On/Off
11. Side Projector On/Off
12. Mute Projector
13. System Off
14. Help information
15. Comfort Monitor On/Off Control

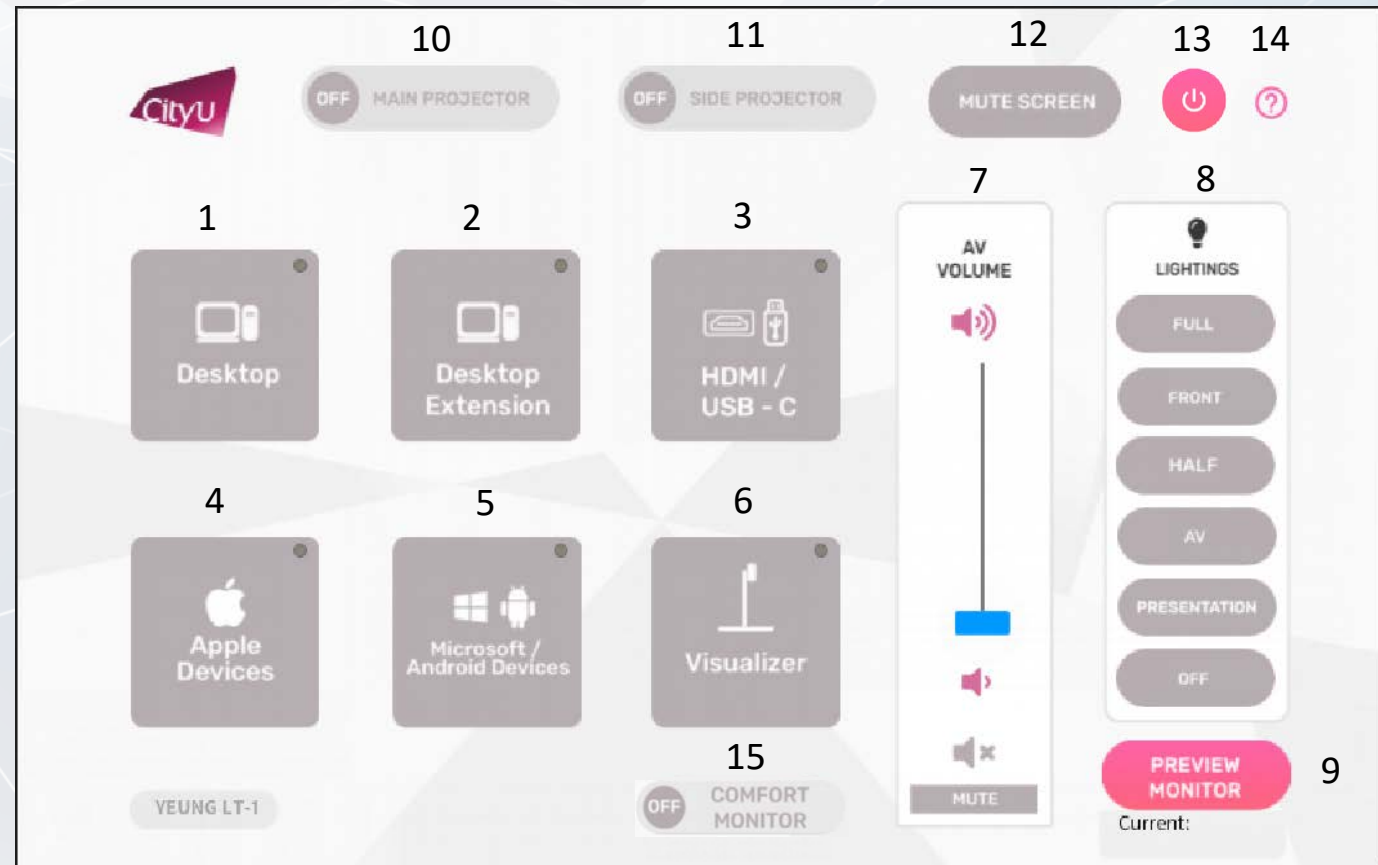

Operation procedure of the Desktop Computer Input

- 1) Press "Desktop " button
- 2) Select Display Devices (BOTH/ Left Projector / Right Projector)

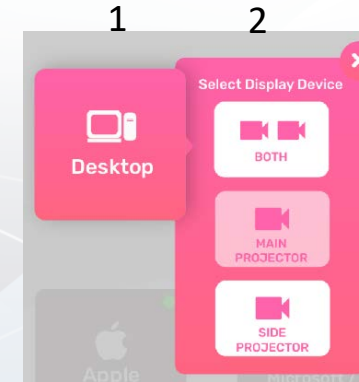

Operation procedure of the Extension Desktop Computer Input

- 1) Press "Extension Desktop " button
- 2) Select Display Devices (BOTH/ Left Projector / Right Projector)

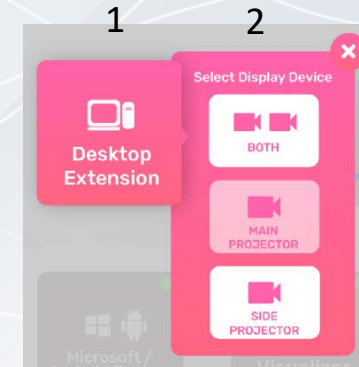

Operation procedure of the Multiport Input

- 1) Press "HDMI / Multiport " button
- 2) Select Display Devices (BOTH/ Left Projector / Right Projector)
- 3) Connect the device to USB-C / HDMI /DVI ...etc cable

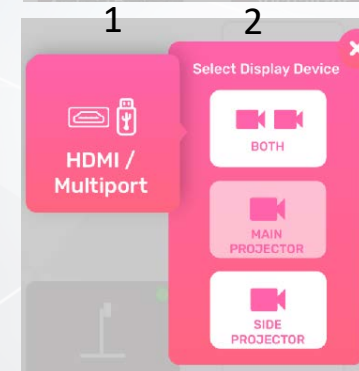

Using AV Equipment

Operation procedure of wireless presentation for Apple Device

- 1) Press “Wireless Presentation (Apple Devices)” button
- 2) Select Display Devices (BOTH/ Left Projector / Right Projector)
- 3) Use Screen Mirroring or AirPlay to connect Apple device

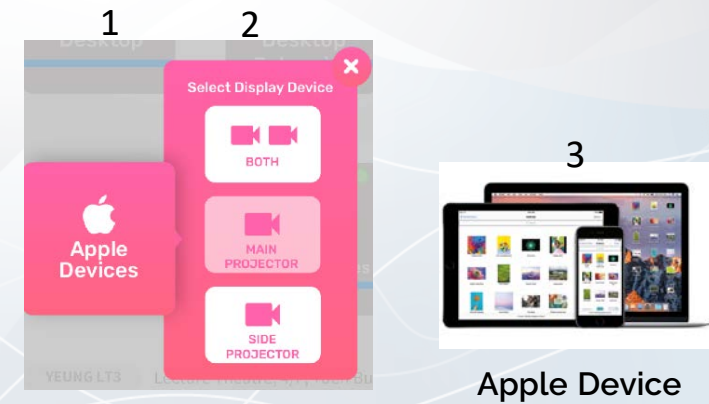

Operation procedure of wireless presentation for Microsoft & Android Device

- 1) Press “Wireless Presentation (Microsoft & Android)” button
- 2) Select Display Devices (BOTH/ Left Projector / Right Projector)
- 3) Use Screen Mirroring to connect Microsoft & Android device

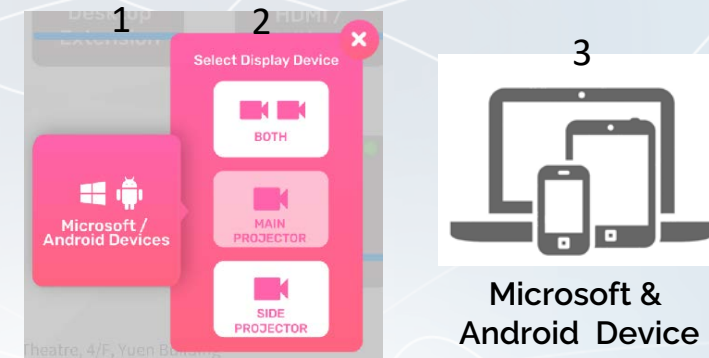

Operation procedure of Visualizer Input

- 1) Press “Visualizer” button
- 2) Select Display Devices (BOTH/ Left Projector / Right Projector)

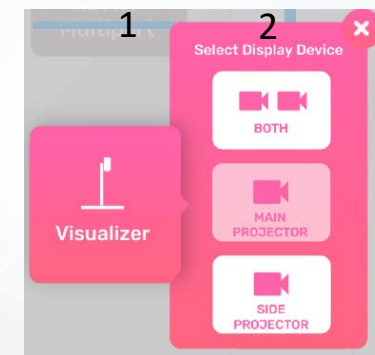

Using AV Equipment

Source to be displayed on Preview Monitor

1. Desktop
2. Visualizer
3. Tracking Cam

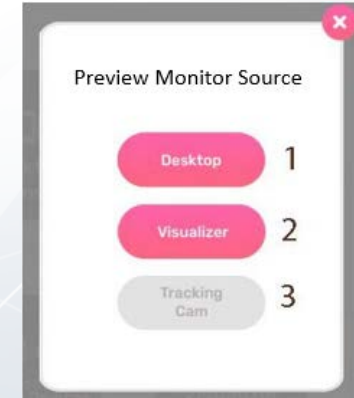

Comfort Monitor On/Off Control

1. Left Monitor Control
2. Right Monitor Control

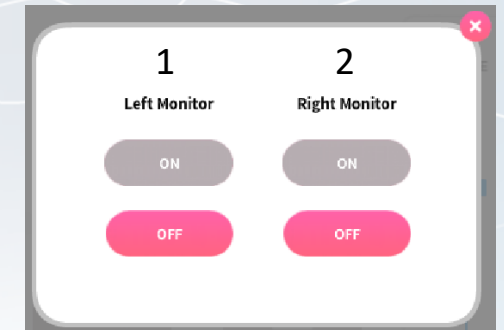

System OFF

1. Confirm Power off
2. Cancel Power off

